



**alitec.at**



**CANYCOM**

**F1-MASAO 2012  
PRO**

CHIKUSSEI INC



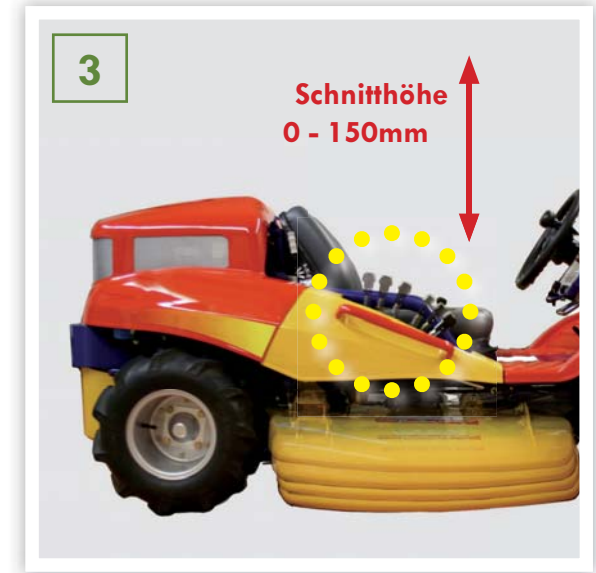
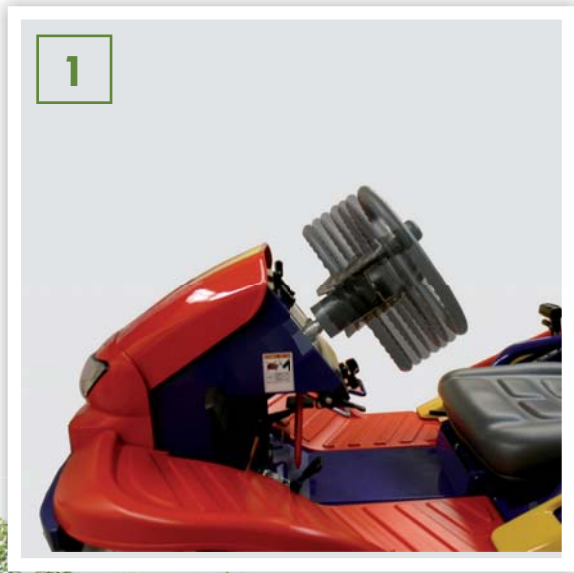

# SPECIAL FEATURES

# DESIGN meets FUNCTION

1 STEERING WHEEL HEIGHT ADJUSTMENT

2 WIDE TILT STEERING 35°, 5 ADJUSTMENTS

3 SLIDING CUTTING HEIGHT LEVER

4 FULLY ADJUSTABLE SUSPENSION SEAT

COMPACT BUILDING METHOD HEIGHT 860 MM

EMPHASIS 455 MM

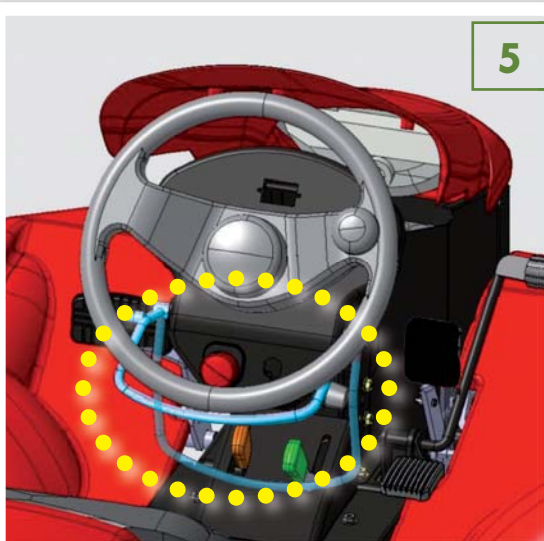

5 BLADE CLUTCH LEVER - EASY TO FIND IN ARM LENGTH



CANYCOM



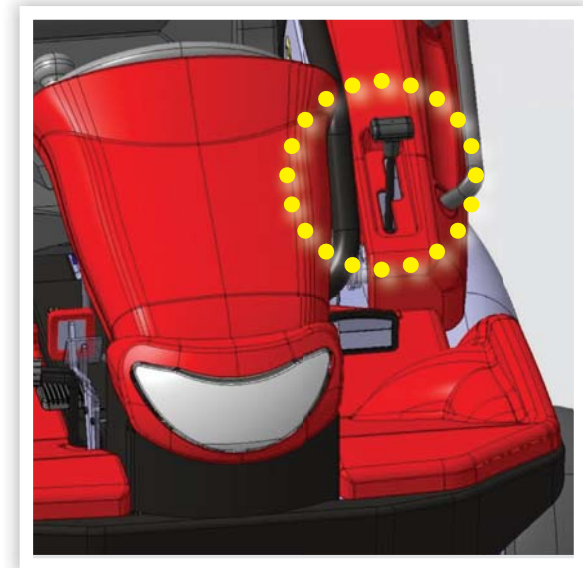
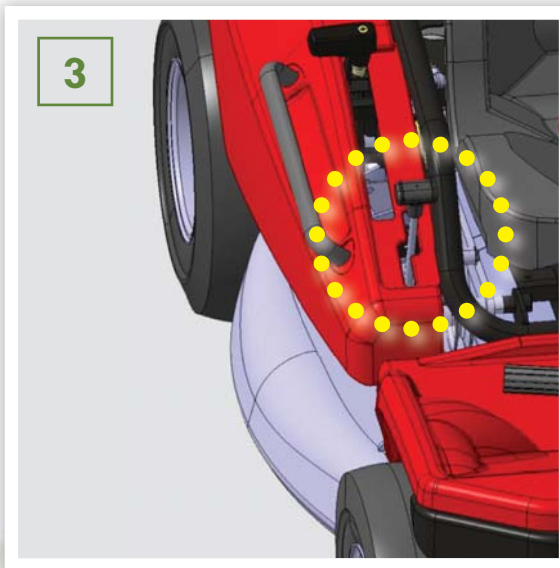
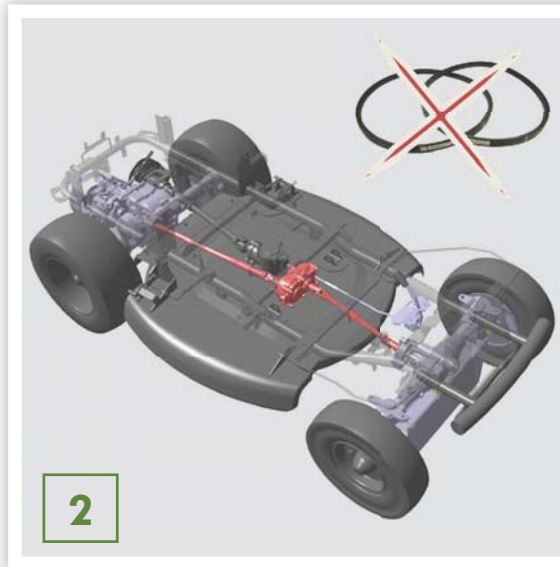
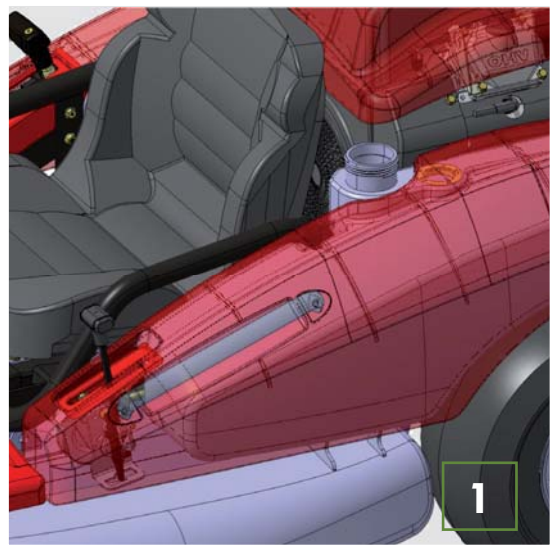

SPECIAL FEATURES

# COLOR meets QUALITY

1 BIG 20 LITER TANK - WORK A WHOLE DAY

2 CUTTING DECK & 4WD - SHAFT DRIVEN

3 ACCELERATOR CAN BE IMPLEMENTED AS LEVER ON LEFT OR RIGHT SIDE OR AS PEDAL

4

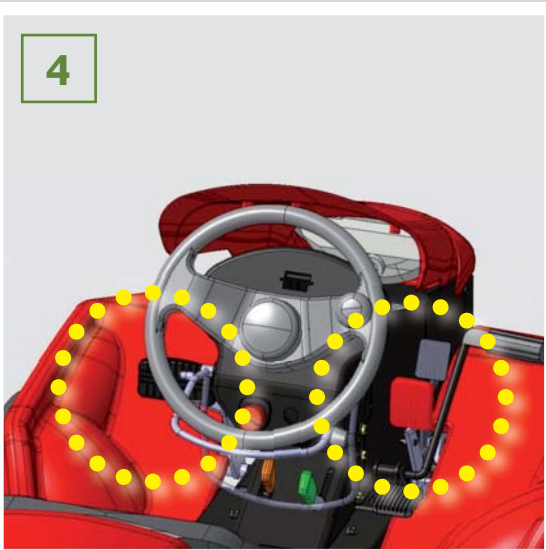

4 BREAK PEDAL MAY BE INSTALLED ON LEFT OR RIGHT SIDE





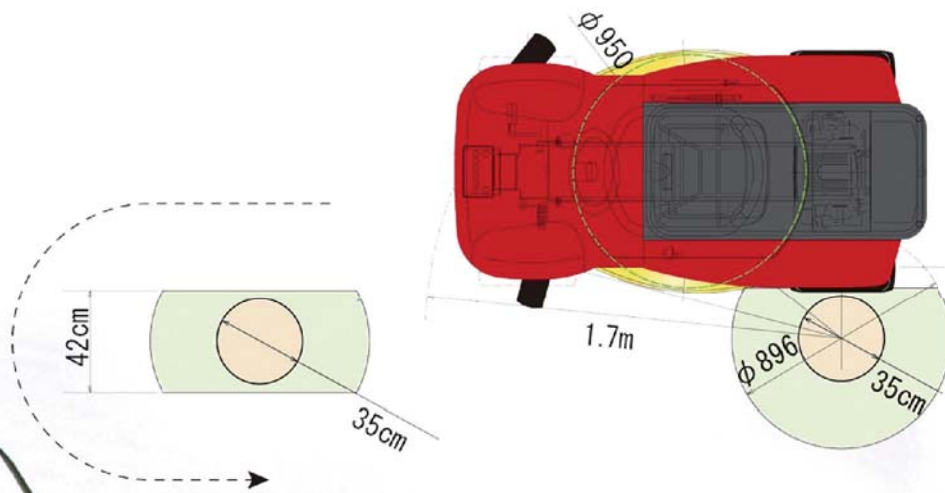

LESS TURNING RADIUS

CIRCUMFERENCE DIAMETER 35CM  
FRONT WHEELS TURN UP TO A 75° ANGLE &  
INSIDE REARWHEEL BRAKES

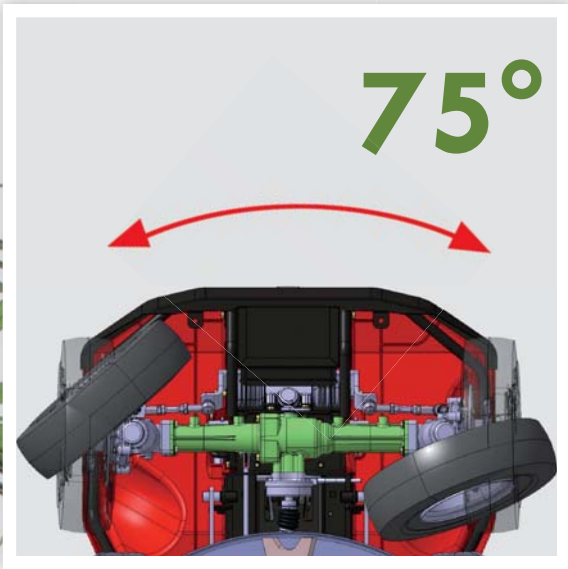

# VERY SMART SOLUTIONS

MORE SPACE FOR GRASS

**NEW BUILDING METHOD**  
UP TO A HEIGHT OF 230 MM THE GRASS  
WON'T BE BROKEN BEFORE CUTTING

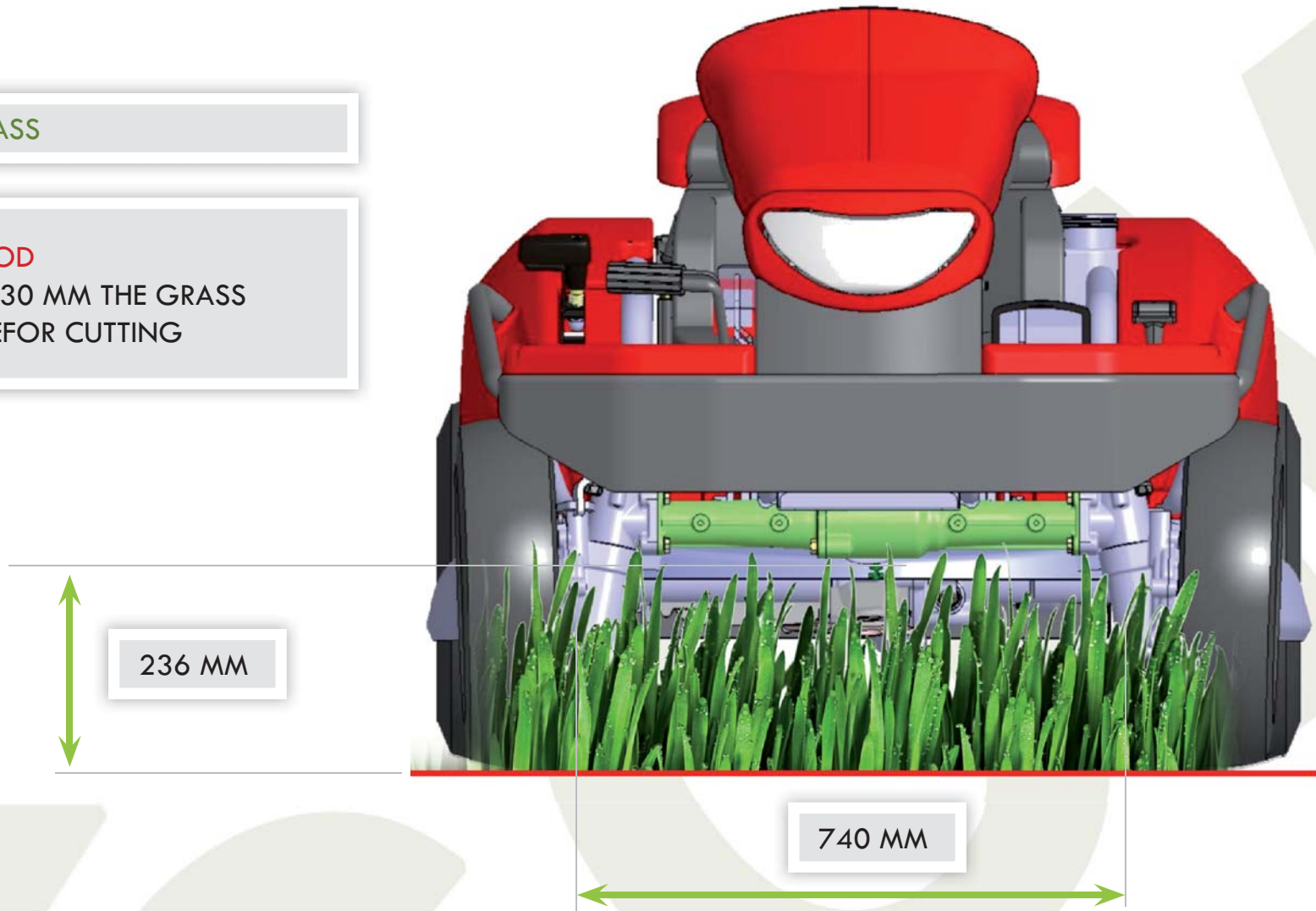



1 MAIN FRAME CONSTRUCTION

2 ENGINE BASE FOR BALANCED WEIGHT

3 HIP GUARD FOR BETTER SEAT COMFORT

4 TOOLLESS BLADE EXCHANGE

5 REDUCED NOISE - FUJI HEAVY INDUSTRIES LOW NOISE MUFFLER

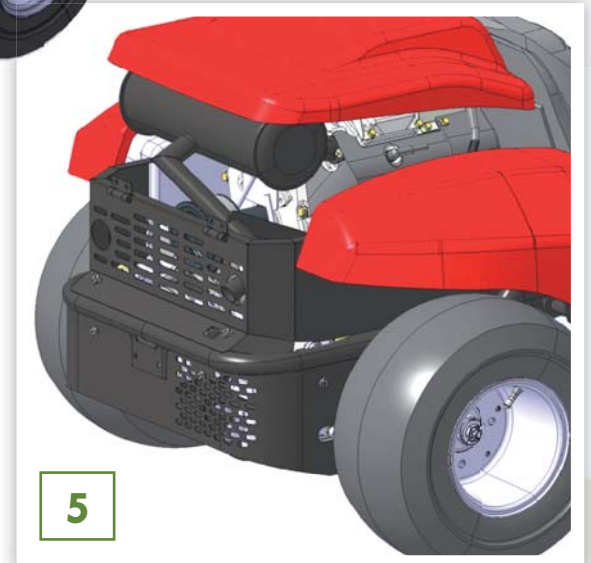
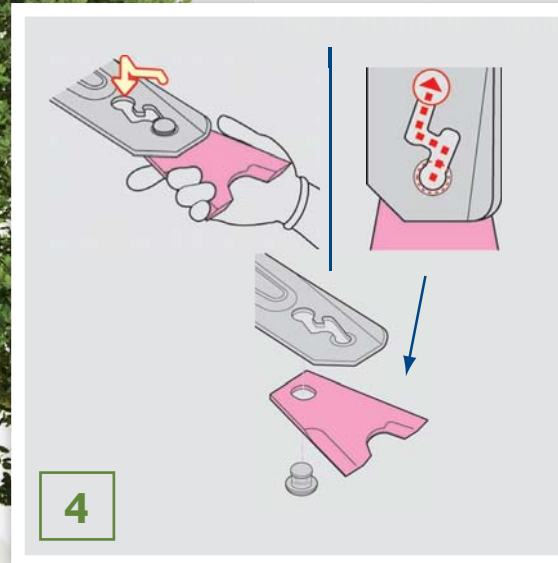
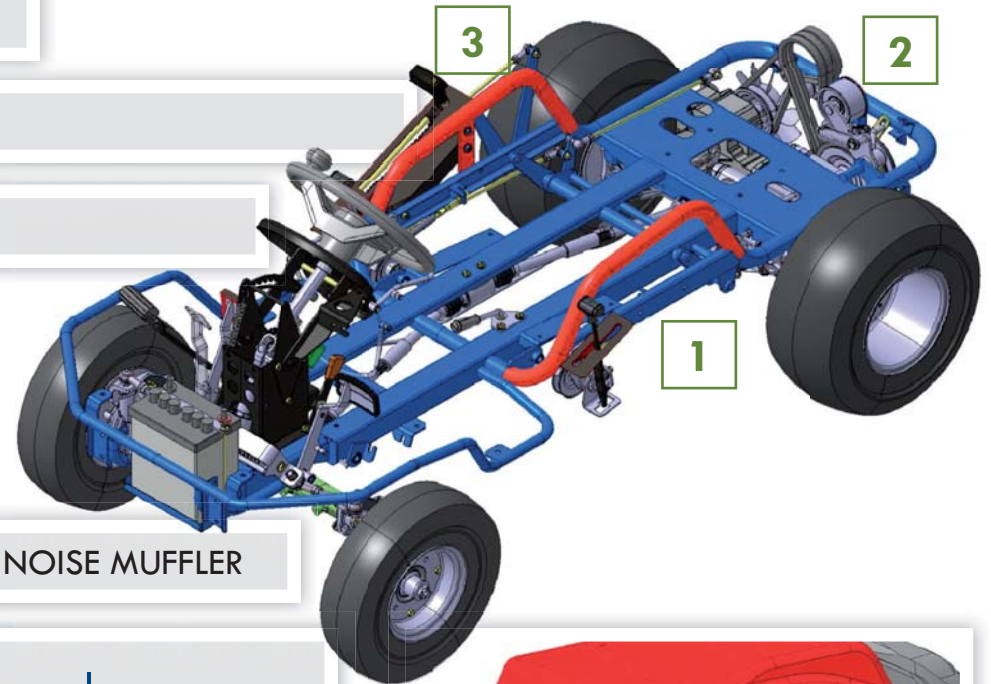

SPECIAL FEATURES



# CM 225

# CMX 224

## 2WD

## 4WD

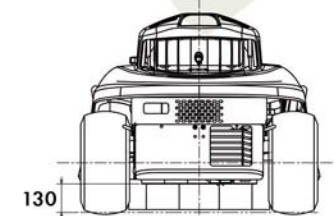
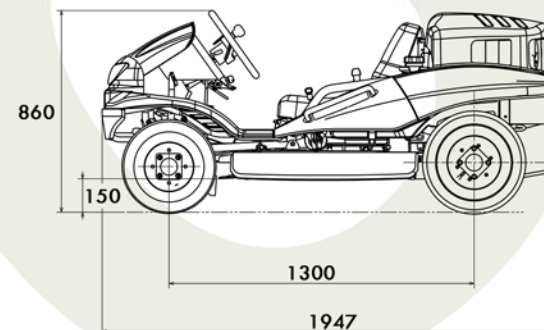
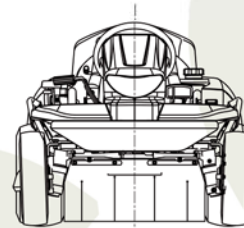
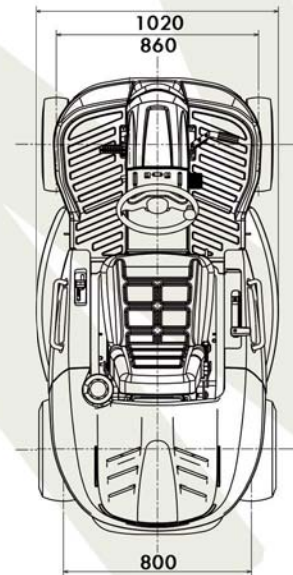

L x W x H in mm	1947 x 1020 x 860
Wheel distance	1300 mm
Tread in mm:	F: 860, R: 800
Ground distance	130 mm
Engine	Subaru Robin EH 65 Auto-Choke
Max. Output	16.4 kW/ 22.0 PS
Start system	Electro start Auto-Choke
Fuel	Petrol
Fuel capacity	20 Liter
Weight	320 kg   340 kg
Rated cutting summery	8.000 m <sup>2</sup> /h
Steering	Adjustable, 2-Wheel
4 WD	-   yes (CMX 224)
HST	„Hydro-Gear“ BDR-319
HST-Oil	20W 50
Diff.-Lock	Yes (powershifting)
Oil cooling system	3,5 Liter
Speed	F: 1. 0-7.7 km/h, 2. 0-13.8 km/h R: 0-6.0 km/h
Turning radius	420 mm
Gradeability	25° / 55% all axles
Front Wheel	AGR 4.00-7", 4PR
Rear Wheel	17x8.00-8", 4PR
Cutting width	975 mm
Cutting height	0 - 150 mm (21-steps)
Sliding deck feature	-
Blade Type	Swinging Blade
Cutting Deck Adjustment	Manual
Cutting Deck	Shaft driven



**CANYCOM**



**CANYCOM**



***alitec.at***

ANN